

**1. Before installation**

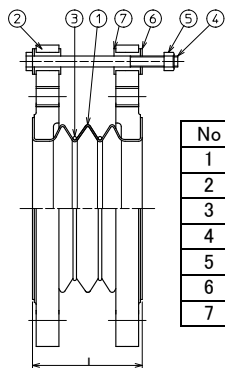

Table 1 ZTF-5000

No	Name	Material
1	Bellows	PTFE
2	Flange	FCD450
3	Control ring	SUS304
4	Stopper bolt	SS400
5	U nats	SS400
6	Washer	SS400
7	Rubber sleeve	CR

Dwg 1

Table 2 Standard Length

Size	L (mm)	Size	L (mm)
25A	45	100A	85
32A	50	125A	100
40A	50	150A	100
50A	70	200A	110
65A	75	250A	120
80A	85	300A	120

The product is delivered under standard length.  
If changed length, adjust it within  $\pm 3$ mm.

**2. Installation**

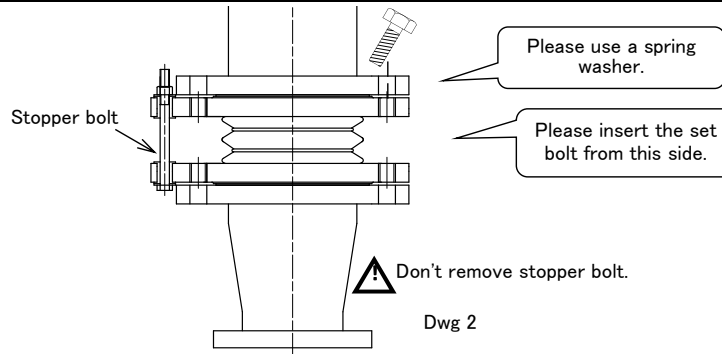

Dwg 2

- Before inserting the product, sealing surface of both product and pipe flanges shall be cleaned up.  
If there are some scale on sealing face of pipe pipe flange, scale should completely be removed by rasp.  
In case of flaw on sealing face, it should be polished and being flat.
- This type of flange is machined screw for setting bolt, so nut is not necessary.  
Insert setting bolt from pipe side which is listed in table 3 each size.

Table 3 Setting bolt specification bolt size x bolt length(mm)

Size	25A	32A,40A,50A	65A,80A	100A	125A,150A	200A	250A,300A
Bolt spec	M16 x 30	M16 x 35	M16 x 40	M16 x 45	M20 x 50	M20 x 55	M22 x 60

**3. Tightening of the bolts**

The order of bolt tightening.

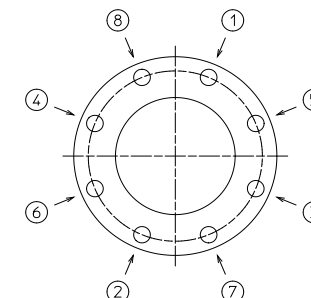

Dwg 3

- Please tighten the bolts diagonally and equally.
- Please tighten the opposite side of flange as same way.

⚠ Please confirm whether the flange face is parallel before tightening.

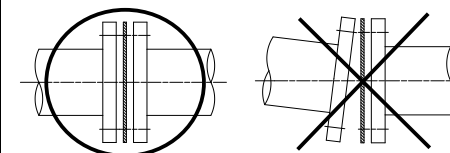

**Completion**

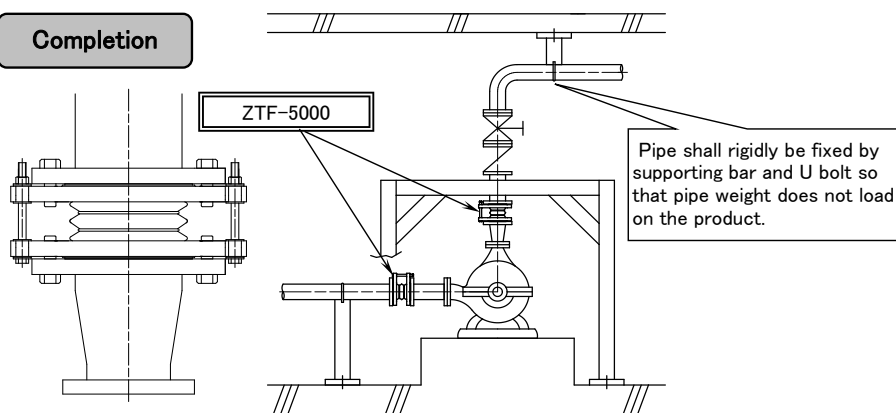

**NOTES**

- This product is not designed for absorb the axial movement but vibrations.
- It is necessary to set up fixing point of pipe near product in order to perform absorbing vibration from pump.
- Please carry out the welding work of the piping before installation of the product. If you have to carry out If you have to weld pipe after installation the product, please take suitable earth, and put protective cover around the product so that it is kept in without any damages.

4) Please select the pipe size not to exceed 3m/s of flow velocity. (inside diameter base)

5) For protecting product, stop valve and check valve are set in order as shown in drawing 4.

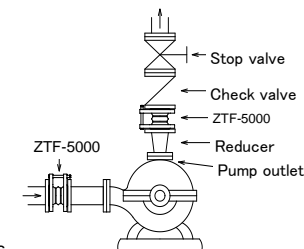

Dwg 4